

Aicube Care-- Care with Love



Guangzhou Selaqua Sanitary Ware Co., Ltd
Jintian Industrial Park, Huadong Town, Huadu District, Guangzhou City, Guangdong Province, China.
www.aicubecare.com; www.selaqua.com

Contact: Katie Peng
Sales Manager
M: +86 18620266308
E: katie@aicubecare.com

PRODUCT DETAILS

Type	Support Rails
Item Code	XHA-U622
Range	Grab Bar
Materials	1. Metal part constructed with super solid aluminum alloy.
Finish	Anozied Matt Black or Bright Chrome or Gold

Technical Details and Descriptions:

Wall mounted grab bar foldable.
Certified Weight loading 120kgs.

Standard and Warranty

Standard	ISO17966
Warranty	Expected service life of the shower grab is 10 years, provided that maintenance is carried out correctly. We makes a commitment to remedy material and manufacturing defects for a period of 3 years from the invoicing date.

Cleanning and Care Guide

- The product is to be cleaned with hot water or a mild soapy cleaning agent.
 - We recommend that chalky deposits be removed from aluminum parts using a solution of 3:7 acetic acid: tap water. When the aluminum parts have been washed down with this solution, the parts must be wiped over with a damp cloth, wrung out in clear water. The product must be wiped down with a soft rag wrung out in clear water immediately after cleaning, as some materials may otherwise be discolored and stained, and the surface coating may deteriorate.
- Warm Note:** Do not use chlorine based, corrosive or abrasive cleaners as it may result in the surface being damaged.

IMAGE



TECHNICAL DRAWINGS

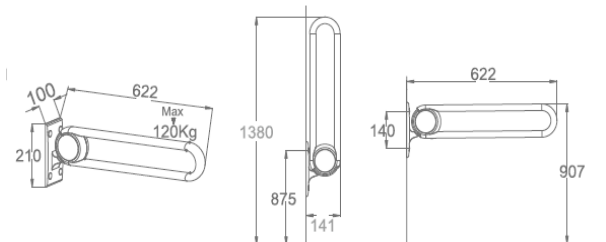

Toilet Grab Bar

Wall Mounted Flip-Up

Solid Metal Wall Fixing with stainless steel screws
INCL. Stainless Steel Screws and Universal Wall Plugs

Ergonomical Rail made of super high quality material
Length-622mm(refer to above drawings)

Weight loading 120kgs certified.

Carton Size:68x25x12cm. Gross Weight: 3.65kgs